

Benefits

- Reduces Impact Sound
- Improves Airborne Performance
- Flexible, Easy to Cut, Simple to Install
- High Performance - Low Profile
- Suitable for use on both Timber and Concrete Floors

Applications

- New Build
- Retrofit Constructions
- Residential Developments
- Hotels

Description

An acoustic flooring underlay which is used extensively by private house holds, property companies, housing associations, contractors and builders.

TVS RESi-Lay Triple is primarily designed for timber floors although it can also be used with concrete floor constructions. It offers additional airborne and impact sound insulation to RESi-Lay Double so is aimed at developments where superior noise control is necessary.

This high performance composite is a sandwich laminate of two layers of TVS RESi Barrier Matt – Model BM0070, separated by a 6mm layer of TVS ABSorb Class O foam.

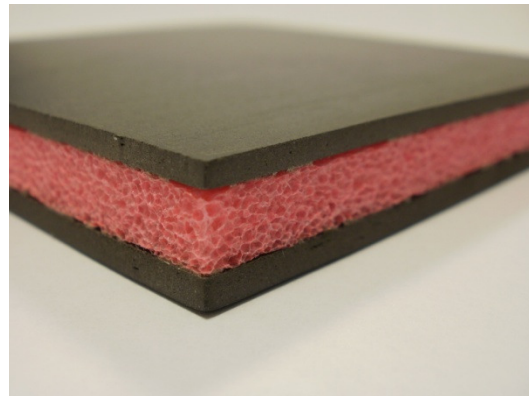

Physical Information

Standard Sheet Size	1200mm x 1000mm
Standard thicknesses	12mm
Density	16 kg/m ²

Technical Information

Timber Floor Airborne and Impact Sound Insulation Data

Airborne sound insulation ($R_w(C;C_{tr})$) 49dB
(Part E 43/45dB minimum)

Impact sound insulation ($L_{n,w}(C_i)$) 55dB
(Part E 62/64dB maximum)

(figures derived from acoustic testing at an independent acoustic test laboratory on a build up as shown in Figure 1)

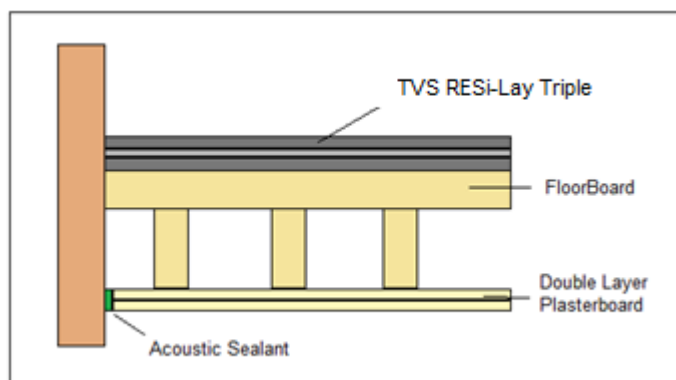

Figure 1.

Impact Sound Improvement on Concrete Floors

ΔL_w (impact improvement) 37dB

Fire Regulations

TVS ABSorb Class O foam is a fully tested fire resistant foam that achieves the fire resistance requirements of British Building Regulations BS476: Part 6 & 7, satisfying the highest level Class 'O'.

Flammability (FMVSS 302)	-	Self extinguishing
ASTM 1692:1974	-	Resists ignition
Service temperature	-	<80°C (continuous) <110°C (short periods)

TVS WB acoustic barrier material is a high-density mineral loaded thermoplastic polymer. Black in colour, ecologically neutral and recyclable it conforms to the following:

Flammability (FMVSS 302)	-	Zero burn rate
Service temperature	-	<90°C (continuous) <120°C (short periods)