

Longline Vision Partitioning Guide

System Description

Longline Vision is a fully glazed frameless partitioning system that combines design aesthetics with outstanding performance. The system offers the opportunity to create partitioning without vertical mullions to a maximum height of 3000mm, and is available in Single and Double Glazed (105mm).

System Features

- A range of stocked head and base tracks to meet project demands
- Certified acoustic and structural performance
- Provides a seamless integration into drywall, to enable part glazed, part drywall installations
- Offered in a large variety of paint finishes

Drywall Integration

Longline Vision can be used as a stand alone glass partitioning system but is also designed to integrate with plasterboard ceilings and Longline Drywall.

Longline Vision allows for seamless integration from glass into solid. Glazed sections recess into drywall junctions to provide a single walled partitioning system of both glass and drywall.

Glass Options

A range of glass options is available including:

- Toughened
- Laminated
- Toughened and laminated
- Electric privacy glass
- Acoustic

Finish

Extruded aluminium profiles available as standard polyester powder coated in RAL9010 and RAL9006. Other colours available to order.

Manifestations

A range of glass manifestations can be supplied and fitted. All manifestations need to comply with Approved Doc M.

Fully Tested

Longline Vision SG glass barriers have been tested to BS 5534 & BS 6180 standards and, under testing, achieved both a "Severe Duty" rating and an excellent "Crowd Pressure" rating of 3.00 kN/m without causing damage to the barrier or fixings. Therefore they are suitable for use as full height glass barriers in critical areas as stipulated within building regulations (Part K).

Further information is available on request.



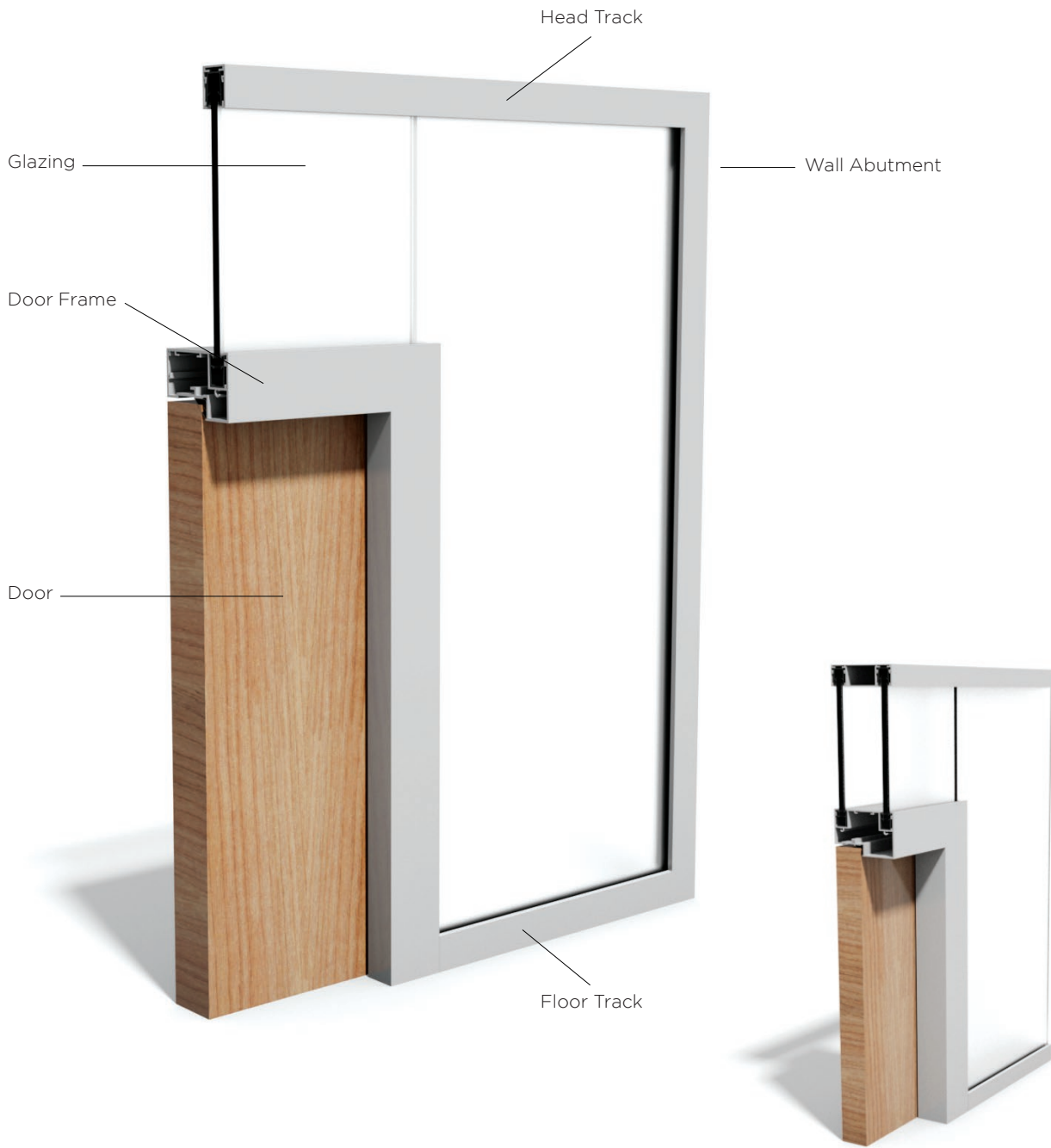

Acoustic Performance Summary

	Acoustic Performance
Longline Vision Single Glazed	Up to 39dB
Longline Vision Double Glazed	Up to 48dB

The data above reflects the results of actual tests conducted in November 2016 on constructions as they would be on site with no additions to aid performance. Certification data available on request.

Structural Performance Summary

BS 5534 TESTING	Structural Performance
Longline Vision Single Glazed	Up to Severe Duty

BS 6180 TESTING	Structural Performance
Longline Vision Single Glazed	Suitable for use as a Barrier

I-Joint (Dry Joint, Clear PET-G)

The crystal clear I-Joint is a low profile dry joint which can be used instead of traditional silicone. It reduces construction build time on site while providing full de-mountability.

Stop press! Glass joints are also available in Piano Black as an alternative to the standard clear, offering a more contemporary look to Longline Vision installations – particularly where black is the colour choice for the framing. A range of black glass door furniture is also available to complement.

Glass Installation

To provide the system's high standards, our own dedicated glass team install all glass for Longline Vision.

Once Longline Vision aluminium head and base tracks are fitted on site, a glass surveyor visits the project and ensures accurate measurements are taken for both glass and any integral blinds.

Standard glass (toughened / laminated) is installed usually within 5 working days. Specialist glass can take up to 4 weeks, subject to specification.

The glass team are also able to offer a range of bespoke glass services, to meet project requirements.

I-Joint

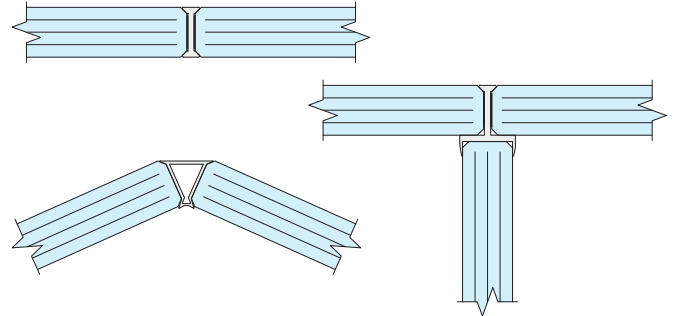

PET-G Corner Joint

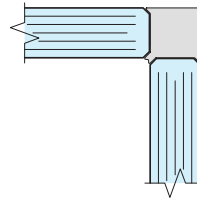

Longline Vision typical elevations

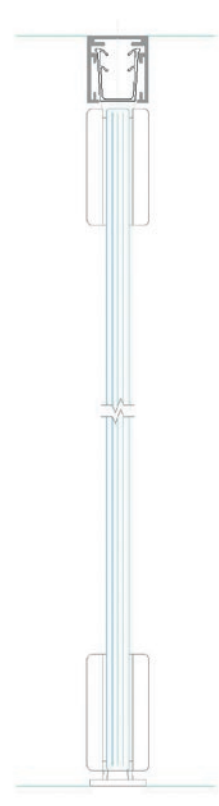
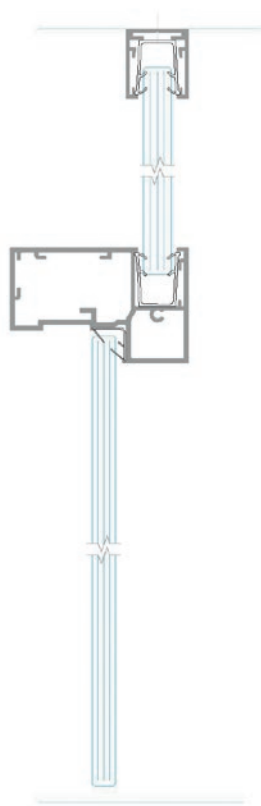
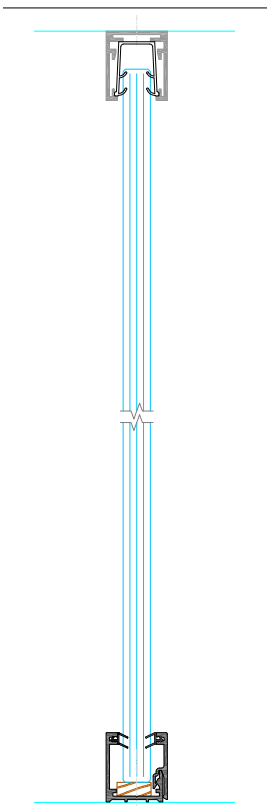
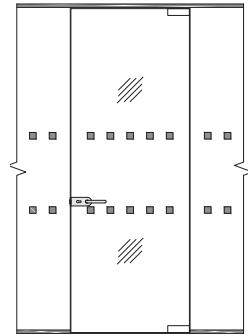
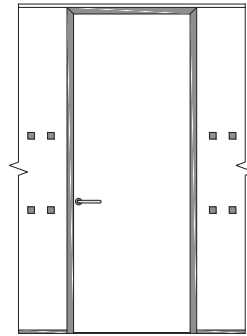
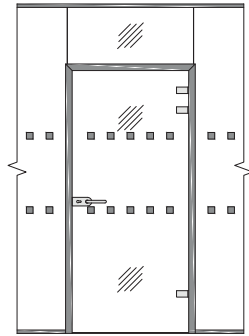
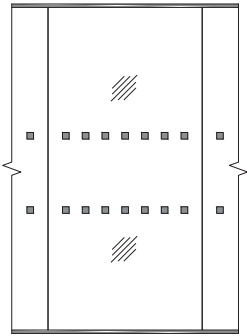

Full Height Single Glazed

Single Glazed Door to Head Height with Glazed Above

Full Height Timber Door

Full Height Frameless Glazed Door

Vision Double Glazing to 100mm Solid Construction

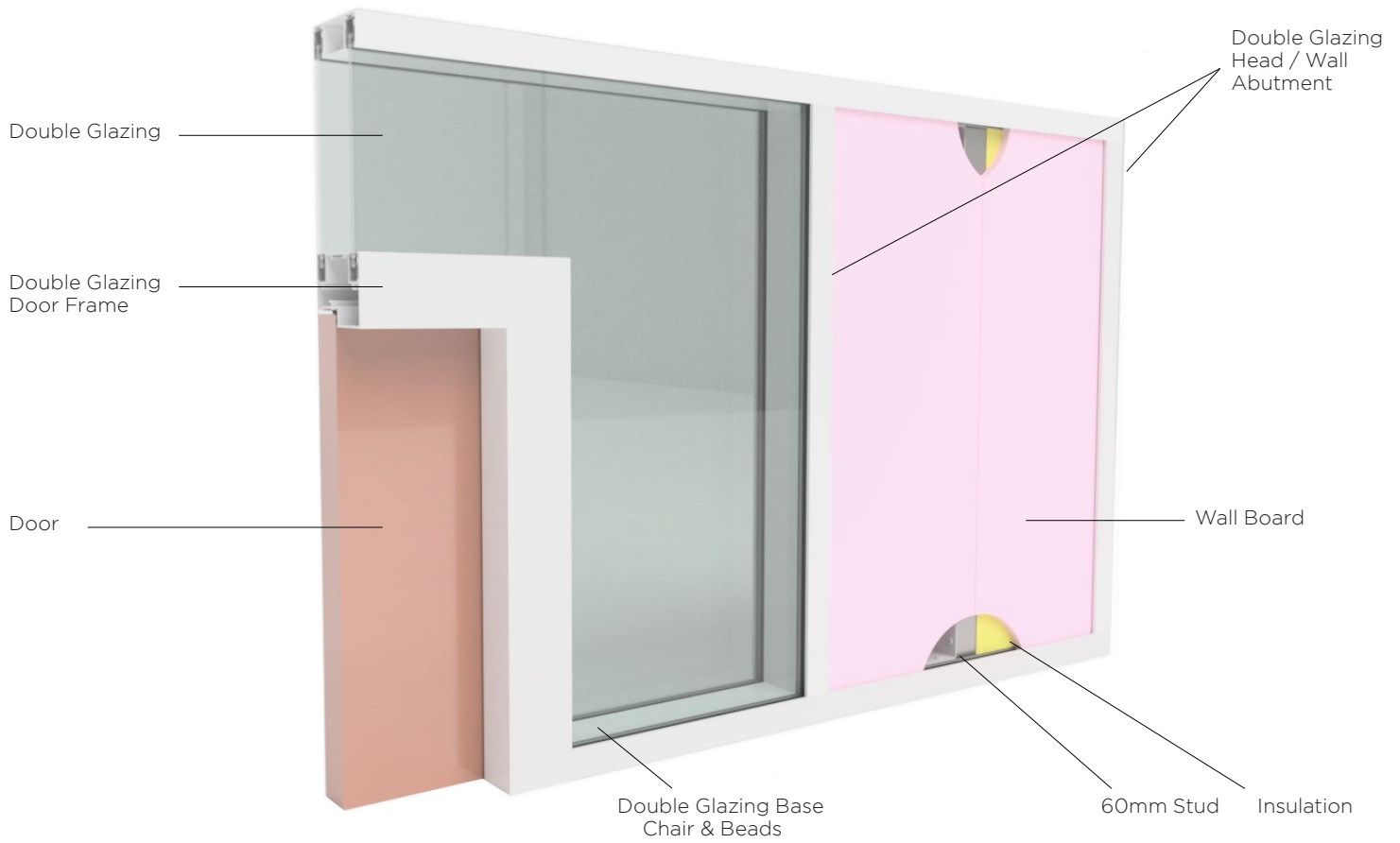

Longline Vision typical elevations

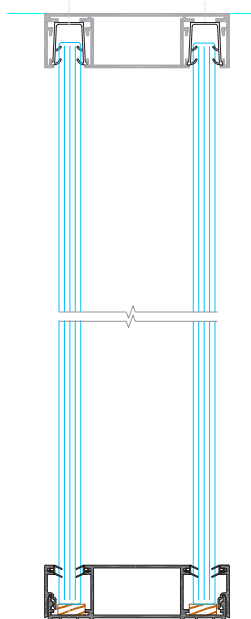

Full Height Double Glazed

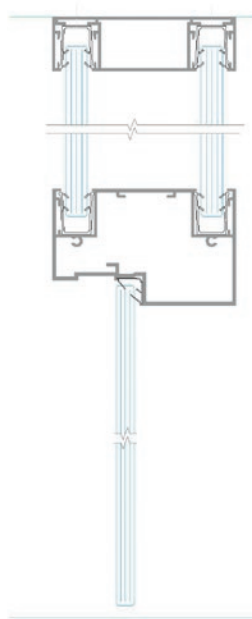

Single Glazed Door to Head Height with Double Glazed Above

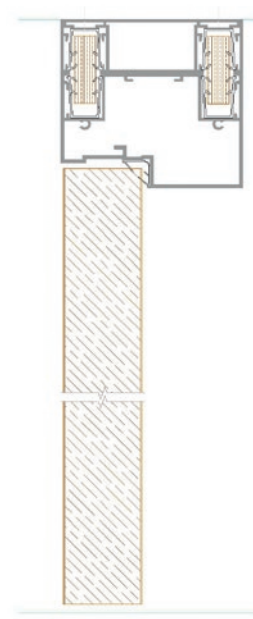

Full Height Timber Door (Double Glazed Track)

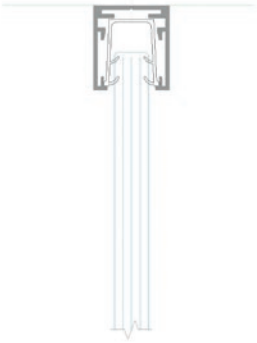

Single Glazed
Head Track
/ U Insert

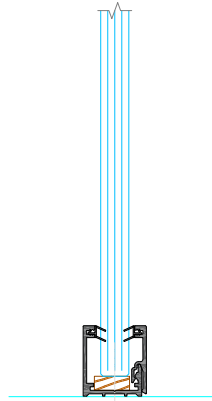

Single Glazed Chair /
Glazing Bead / Flipper
Gasket x2

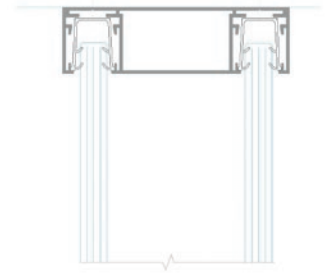

Double Glazed
Head Track
/ U Insert x2

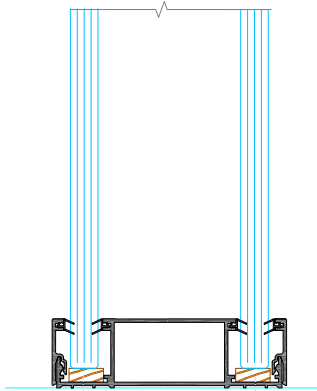

Double Glazed Chair /
Glazing Bead x2 / Flipper
Gasket x4

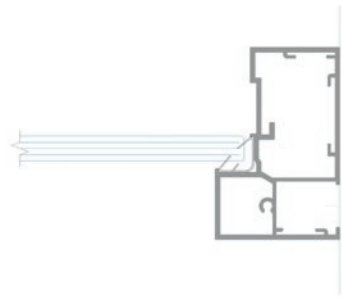

Single Glazed Door
Frame to Solid
Abutment



Single Glazed Door Frame
Glass to Glass (Timber Door)

Single Glazed Door Frame Glass to Glass (Timber Door)

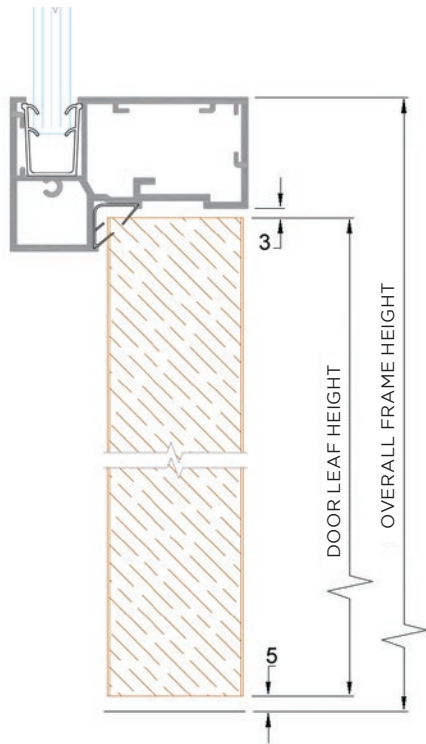

Overall frame height = door leaf height + 44mm

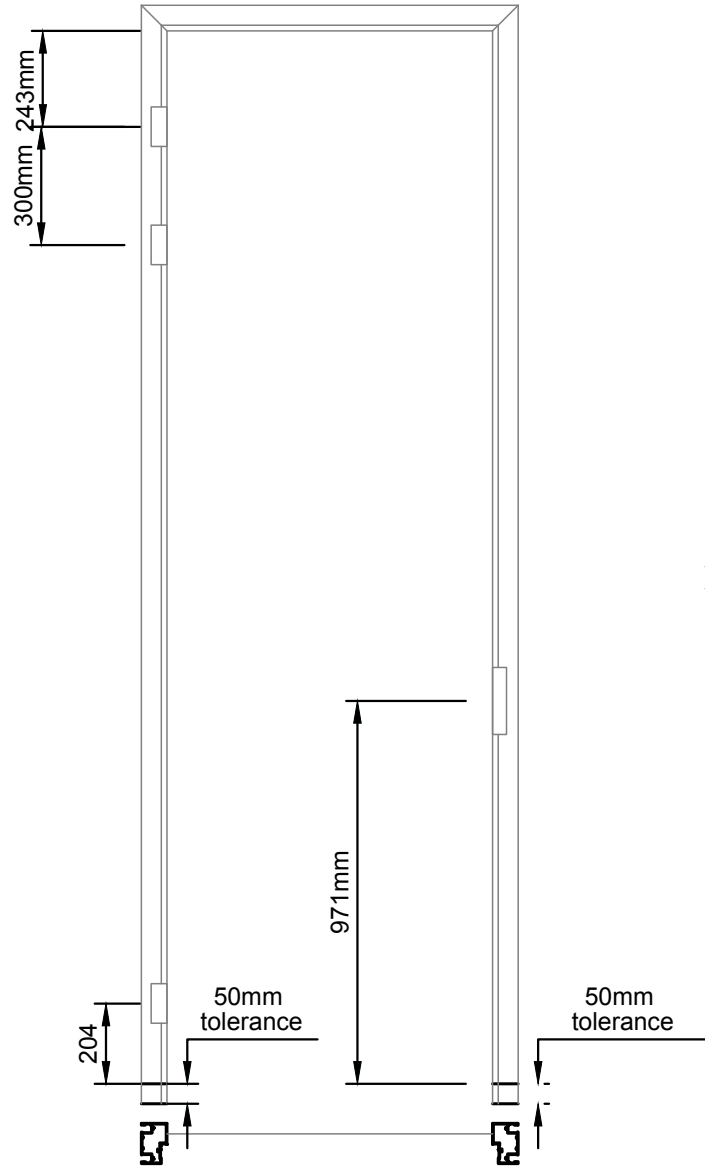

Typical set out of lock plate and hinges to suit timber door (2.7m) in Longline Vision frame.

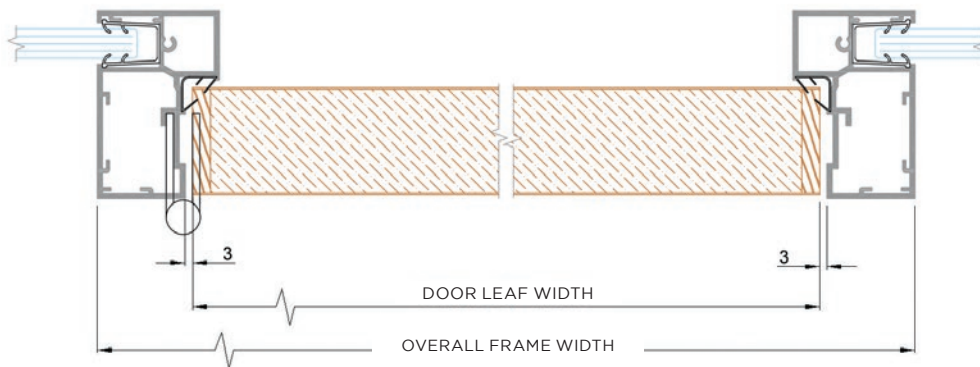

Overall frame width
 Single doors = door width + 78mm
 Double doors = door width + 80mm
 Please note: for double doors add 2mm to the combined door leaf width.

Please note on a standard door 1981/2040 high, where required the lock strike is milled to locate the centre of the lever handle at 1021 (includes 50mm tolerance at bottom of frame leg for trimming on site to suit floor levels). Where doors are full height or non standard please specify the position of the strike when ordering.

Double Glazed Door Frame Glass to Glass (Timber Door)

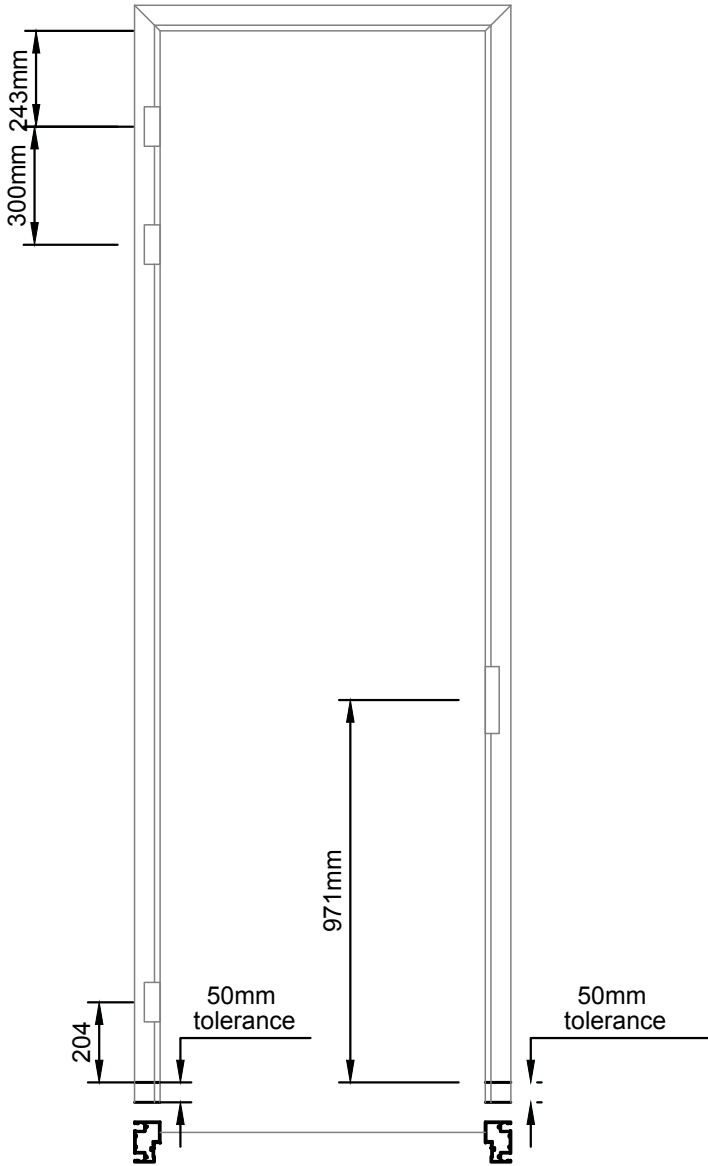

Typical set out of lock plate and hinges to suit timber door (2.7m) in Longline Vision frame.

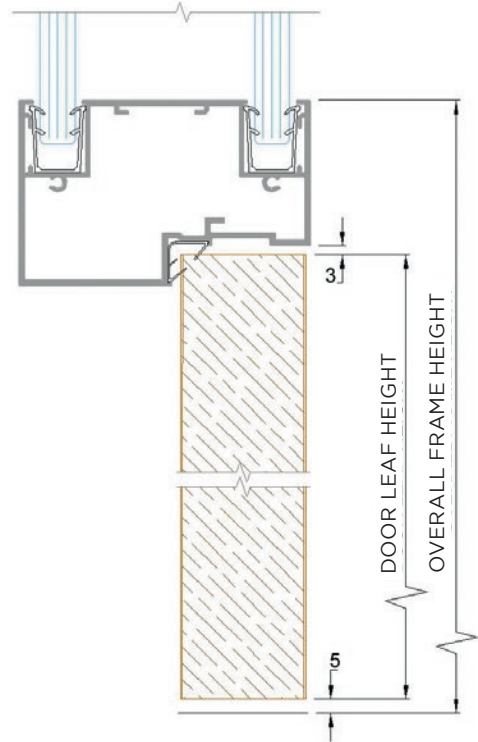



Overall frame height = door leaf height + 59mm



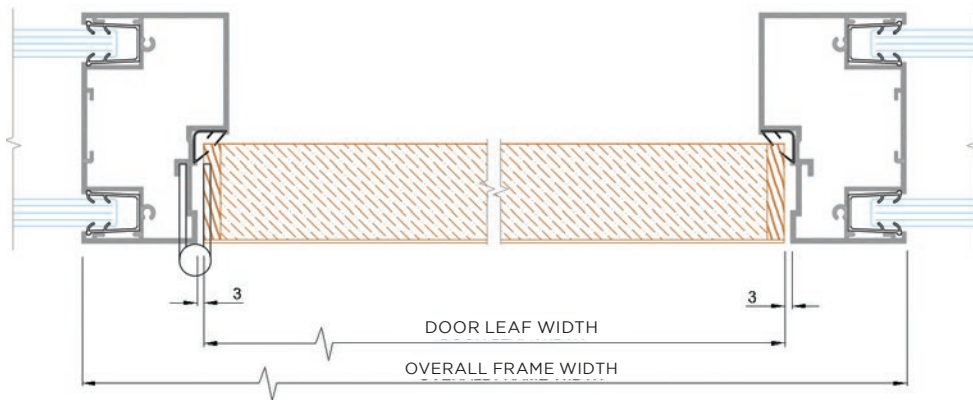

Overall frame width
Single doors = door width + 108mm
Double doors = door width + 110mm

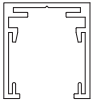
Please note: for double doors add 2mm to the combined door leaf width.

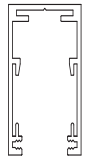
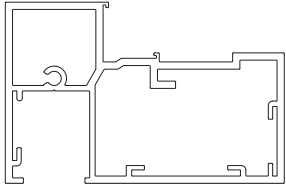

Please note on a standard door 1981/2040 high, where required the lock strike is milled to locate the centre of the lever handle at 1021 (includes 50mm tolerance at bottom of frame leg for trimming on site to suit floor levels). Where doors are full height or non standard please specify the position of the strike when ordering.

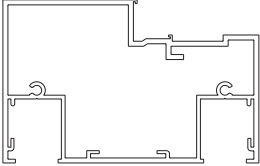
Profile	Product Ref / Description	Nominal Length (mm)
	Single Glazing Head / Wall Channel (Standard 30mm)	3000
	Single Glazing Chair	3000
	Glazing Bead (1 no Required per 3000mm Single Glazing run or 2 no for Double Glazing)	3000
	Single Glazing Head / Wall Channel (40mm)	3000
Single glazing door frame kits (inc. hinges, seals, brackets etc.)		
	Single Glazing Door Frame Pack (Timber Door)	1981 x 838
	Single Glazing Door Frame Pack (Timber Door)	2040 x 926
	Single Glazing Door Frame Pack (Timber Door)	2700 x 926
	Single Glazing Door Frame Pack (Double Timber Door)	1981 x 1676
	Single Glazing Door Frame Pack (Glass Door)	Up to 2040 x 926
	Single Glazing Door Frame Pack (Glass Door)	Up to 3000 x 926
	Single Glazing Door Frame Pack (Double Glass Door)	Up to 3000 x 1852

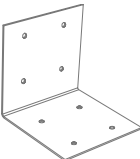
Profile	Product Ref / Description	Nominal Length (mm)
	Double Glazing Head / Wall Channel	3000
	Double Glazing Chair	3000
Double glazing door frame kits (inc. hinges, seals, brackets etc.)		
	Double Glazing Door Frame Pack (Timber Door)	1981 x 838
	Double Glazing Door Frame Pack (Timber Door)	2040 x 926
	Double Glazing Door Frame Pack (Timber Door)	2700 x 926
	Double Glazing Door Frame Pack (Double Timber Door)	1981 x 1676
	Double Glazing Door Frame Pack (Glass Door)	Up to 2040 x 926
	Double Glazing Door Frame Pack (Glass Door)	Up to 3000 x 926
	Double Glazing Door Frame Pack (Double Glass Door)	Up to 3000 x 1852
	Solid to Double glazing components	
	60mm Galvanised metal stud	
	Metal stud bracket	

Gaskets, infills and accessories (single & double glazing)

Profile	Product Ref / Description	Nominal Length (mm)
	"Flipper" Glazing Gasket Per Each (2 no required per 3000mm Single Glazing run or 4 no for Double Glazing run)	3000
	PVC "U" Gasket (Black Only) Per Each (1 no required per Single Glazing run or 2 no for Double Glazing run)	3000
	Powdercoated Steel Capping Section (To blank off over Full Height Single Glass Door)	1000
	Powdercoated Steel Capping Section (To blank off over Full Height Double Glass Door)	2000
	MDF Full Height Door Frame Insert	-
	Pivot Block (Full Height Frameless Glass Door)	-
	End Cap (Frameless Glass Doors) (2 no required)	-
	Acoustic Door Frame Seal (Stocked in 3000mm lengths in Black)	-
	Straight Cleats	-
	90 Degree Cleats	-
	135 Degree Cleats	-



Longline Vision

method of build

1. Accurately mark out the partition layout, ensuring all is level and square.
2. Cut to required length head / wall channel.

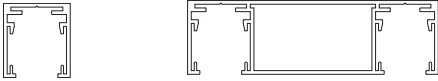

(Single or Double Glazing)

Fix with suitable screws to soffit / ceiling, ensuring a secure fixing can be made at all perimeters, consider the use of plywood pattresses above ceiling if necessary. Square cut wall to wall, if straight run, mitre at corners, if other glass runs are abutting.

3. Cut as above and insert PVC "U" gasket into head channel (2 no if Double Glazing).



4. Wall abutment one

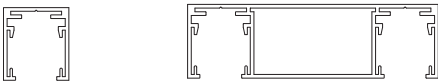

Cut to required length head / wall channel.
(Single or Double Glazing)

To fit under head and down to finished floor level.

Repeat step 3 with PVC "U" gasket.

5. Wall abutment two

(Used in a "trapped glazing" scenario at the end of a run or between a door frame and wall)
Cut to required length glazing chair.

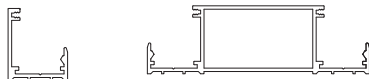

(Single or Double)

To fit under head and down to finished floor level.

6. Push fit or slide rubber "Flipper" gasket into barbed rebate in chair.



(2 no for Double Glazing)

7. Cut to required length glazing bead to fit under head and down to finished floor level.



Insert "Flipper" gasket and leave assembly loose for the glaziers to fit.



(2 no assemblies required for Double Glazing)

8. Base Chair

Cut to required length glazing chair.

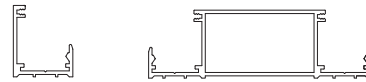

(Single or Double Glazing)

(Refer to item 12 or 15 before cutting)

Cut to fit between inner edges of wall abutments and any door frame legs (See item 12), if fitted, leaving a gap for any frameless doors, if required (See item 15).

9. Base Bead

Cut to fit as above. (1 no Single Glazing, 2 no Double Glazing).



Fit "Flipper" gasket to bead and chair and leave bead loose for glaziers to fit after glazing.



10. Solid Boarded to Frameless Glass

Double Glazing head and base tracks are fitted in the normal way as for the glazed system, with the addition of 60mm galvanised metal "C" stud bracketed top and bottom centrally on the inside faces of the aluminium sections.

The studs are usually spaced at 600mm centres to suit 1200mm wallboards. 12.5mm gypsum wallboard is then inserted into the head section PVC "U" gasket and fixed to the studs in the normal manner.

The boards are then trapped at the base by the glazing bead and "Flipper" gasket as the glass would be in a double glazed construction. The boards are jointed by your preferred method.



11. Solid Boarded to Frameless Glass Transition Abutment

The Double Glazing head / wall channel is used by fitting the flat back against the end stud (boxed with timber infill, recommended) and bracketing inside the glazing pockets of both this upright and the head and base of the abutting glazing tracks. If the continuing glazing is single the redundant glazing channel in the Double Glazing head and wall upright is blanked off using the powdercoated steel capping section.



This method of construction gives a seamless appearance continuing the line of both the head and base along the sight line of both solid and glazed.



12. Longline Vision Slimline Door Frames

If door frames are to be incorporated into the construction, cut the base assemblies to butt up to the frame legs. Brackets are supplied with the frame pack to fix legs to the floor, clip PVC “U” gasket to glazing channels in the back of door frame once assembled.

If door frame is standard height “Halo” i.e. not to the full height of the partition, it is common practice to safely support the frame in position with a timber off cut or some such, from the door head to partition head thus allowing the glaziers to measure and secure the frame when the glass is fitted.

- 13. When fitting a full height door frame, the frame head is usually fitted beneath the partition head and located by the addition of the MDF fillets supplied.



Located in the back of the door head and in the partition head channel and side brackets. (2 no on Double Glazed)

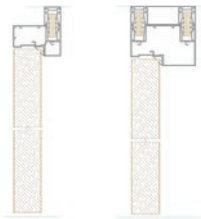

Alternatively, if preferred, the partition head can be cut to each side of the door frame and fixed to the soffit independently and the head channel bracketed to each side of the frame legs.

- 14. When glass doors are to be fitted on side hung hinges within a Longline Vision slimline frame, please ensure the supplied 32mm x 3mm aluminium flat bar is inserted down the full length of the frame cavity on the hinge side leg and the hinge screws are located through it in order to facilitate the most secure fixing, as shown:

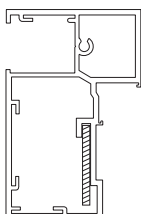

15. Frameless Doors

For “Halo” type frameless glass doors the only change to the standard construction is that a gap is left of the required size to accommodate the door in the base assembly and 2 no (to each door) end caps are supplied to blank off after fitting of the glass.

- 16. In the case where full height glass doors are to be fitted, a block & pivot set can be installed in the head channel before it is fitted to the soffit. Alternatively a “Flat plate” type pivot can be mounted to the face of the steel capping section and screwed through the partition head channel.

The PVC “U” gasket is omitted from the section above the door and the open area of the channel blanked off with the “powdercoated steel capping section”.

N.B. Ensure there is clearance for floorspring assembly when incorporating frameless doors.

17. Sliding Glass Doors

Various types of sliding door tracks and gears are on the market.

The “Trojan” type is a 40mm deep track which is independently fitted adjacent to the partition head track (Vision 40mm head channel) to accommodate the running gear and the glass door. This type of track must be fitted to a substructure capable of taking the weight of the door assembly.

The “Manet” type is an exposed finish round bar track which is fitted to the glass side and over panels which require drilling to accept the stainless steel fittings. All are exposed as a feature of the partition.

18. Manifestations

There is an endless variety of designs available in applied film manifestation ranging from standard “off the shelf” to customer’s own specification (requiring a suitable digital image being supplied).

However, with Health & Safety in mind there is a minimum requirement set out in Building Regulations Part “M” which is most economically satisfied by the application of a double row of 50mm dots or squares in the configuration shown below. (850mm to 1000mm & 1400mm to 1600mm above floor level).

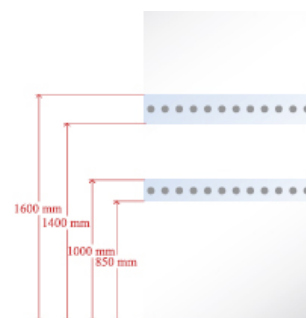



National Distribution

Aberdeen (Encon & Nevill Long)

Tel: 01224 619 380
email: aberdeen@encon.co.uk

Belfast (Encon & Nevill Long)

Tel: 0289 045 4646
email: belfast@encon.co.uk

Birmingham (Encon)

Tel: 0121 356 0606
email: birmingham@encon.co.uk

Birmingham (Nevill Long)

Tel: 0121 506 1710
email: birminghamnl@nevilllong.co.uk

Bristol (Encon & Nevill Long)

Tel: 0117 980 2100
email: bristol@encon.co.uk

Cardiff (Encon & Nevill Long)

Tel: 02920 895 040
email: cardiff@encon.co.uk

Dundee (Encon & Nevill Long)

Tel: 01382 610 040
email: dundee@encon.co.uk

East London (Encon & Nevill Long)

Tel: 0208 526 8440
email: eastlondon@encon.co.uk

Fareham (Encon & Nevill Long)

Tel: 01329 230 555
email: fareham@encon.co.uk

Glasgow (Encon & Nevill Long)

Tel: 0141 641 0011
email: glasgow@encon.co.uk

Leeds (Encon & Nevill Long)

Tel: 0113 220 7000
email: leeds@encon.co.uk

Maidstone (Encon & Nevill Long)

Tel: 01622 713 400
email: maidstone@encon.co.uk

Newcastle (Encon & Nevill Long)

Tel: 0191 293 1090
email: newcastle@encon.co.uk

Newmarket (Encon)

Tel: 01638 667 208
email: newmarket@encon.co.uk

North West (Encon & Nevill Long)

Tel: 01257 248 220
email: northwest@encon.co.uk

Northampton (Encon & Nevill Long)

Tel: 01604 667 430
email: northampton@encon.co.uk

Nottingham (Encon & Nevill Long)

Tel: 0115 978 0040
email: nottingham@encon.co.uk

Oxford (Encon Technical Solutions)

Tel: 01844 204 510
email: oxford@encon.co.uk

Plymouth (Encon & Nevill Long)

Tel: 01752 333 720
email: plymouth@encon.co.uk

Thetford (Nevill Long)

Tel: 01842 777 711
email: thetford@nevilllong.co.uk

Washington (Encon Technical Solutions)

Tel: 0191 419 0066
email: washington@encon.co.uk

West London (Encon & Nevill Long)

Tel: 0208 831 1530
email: westlondon@encon.co.uk

Witney (Encon & Nevill Long)

Tel: 01865 734 500
email: witney@encon.co.uk

Wetherby (Head Office)

Tel: 01937 524 200
email: info@encon.co.uk

KEY

- Dedicated Nevill Long Branches
- Encon & Nevill Long
- Encon
- Head Office

